

OPPORTUNITIES

Frontage Cafe

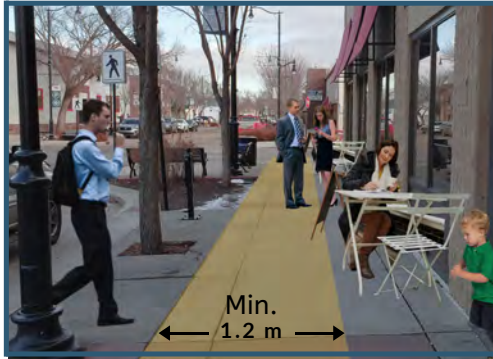

Corner Cafe



Curbside Cafe



Park-let Cafe

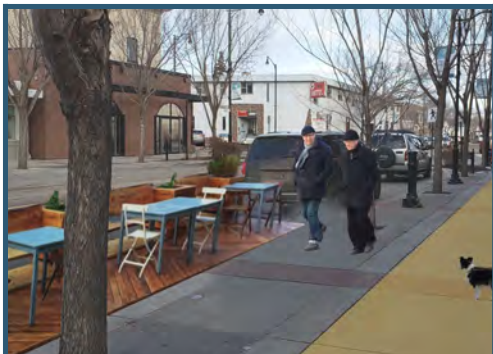

TYPES

Frontage Cafe

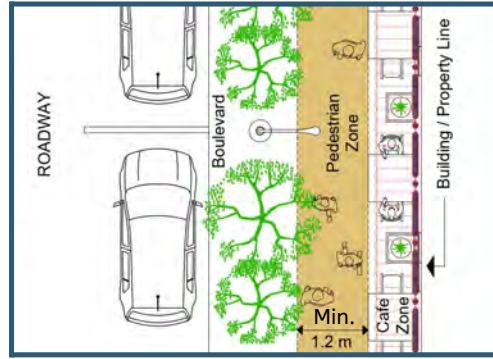

Corner Cafe

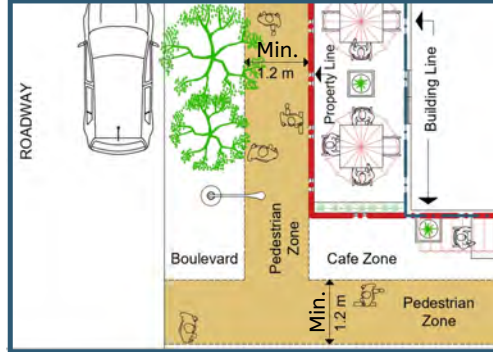

Curbside Cafe

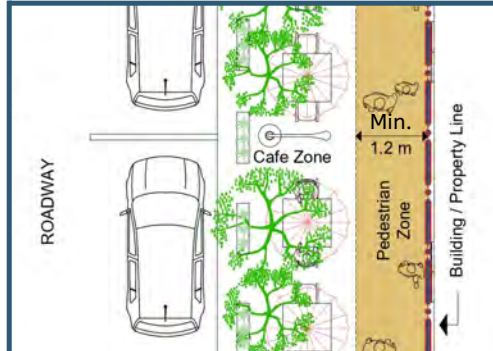

Park-let Cafe

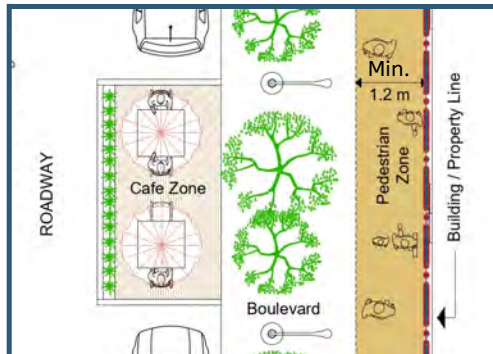

SIDEWALK CAFE BENEFITS



Inviting



Bustling Streets



Increased Sales



Increased Foot Traffic



Options for Pet owners



Better Appeal
Better Marketing

WHY APPLY?



HOW TO APPLY?

1. Complete Sidewalk café permit application form.
2. Provide a proof of Liability Insurance listing the City as an additional insured, and a minimum \$2,000,000 Commercial General Liability.
3. Submit a proposed site plan with sidewalk café dimensions, setbacks from property line and a seating layout.
4. Provide a proof of Food Handling Permit issued from Alberta Health Services (AHS).

*A Liquor License (if liquor is served) issued from Alberta Gaming, Liquor and Cannabis (AGLC) to be provided upon conditional approval.

*Refer to sidewalk café guidelines available at fortsask.ca/sidewalkcafes

*Sidewalk café permit will need to be renewed every year. Any alterations to an existing sidewalk café setup will require a new sidewalk cafe permit.

APPLICATION PROCESS - 2 WEEKS



OPERATIONAL REQUIREMENTS

- Sidewalk Cafés can only be operated in downtown, by restaurants, bars and cafes located on the ground floor level.
- Provide a 1.5 m preferably or at least 1.2 m of unobstructed pedestrian sidewalk and clear entrance.
- Cafe operator is responsible for snow removal from the pedestrian walking area and clean-up of any spills.
- A temporary deck may be allowed, if minimum width of 1.2 m cannot be provided. It must accommodate drainage along the gutter line and must be easy to remove. Applicant needs to be aware of the street cleaning and snow removal schedule.
- Cafe furniture must not be secured to public property or anchored into the pavement without City permission.

DESIGN GUIDELINES



Furniture should be consistent in theme, outdoor durable, safe, movable and not more than 4 tables or 12 seating spaces.



Umbrellas should be safe, outdoor durable, non-combustible and have a minimum 1.98m clearance in height from grade.



Planters and flower boxes should be planted with live seasonal blooms or ornamental evergreens and must not obstruct pedestrian travel and internal movement.



Signs must adhere to Sidewalk Cafe Guidelines and must not restrict pedestrian traffic.



Liquor serving establishments must suitably define patio space with sturdy, durable and movable barrier following AGLC guidelines.



Awning and Canopies must adhere to City of Fort Saskatchewan Land Use Bylaw and must not encroach across title boundaries.



Outdoor heating devices including radiant heating, propane, and natural gas are permitted to be operated with manufacturer's specifications and smoking is prohibited within Sidewalk Cafe areas.

CONTACT US

Planning & Development
City Hall
Ph: 780-992-6198
www.foortsask.ca

SIDEWALK CAFE PROGRAM



**NO APPLICATION FEE
SET UP YEAR ROUND CAFES IN 2 WEEKS**



CITY OF
FORT SASKATCHEWAN